

## Technical Data Sheet

# Modulo Slimline Behind the Mirror Hand Hygiene System 2L Touch-Free Soap Dispenser

---

Applicable to products:

92400BK Modulo Slimline 2L Soap Dispenser Battery Powered  
92401BK Modulo Slimline 2L Soap Dispenser Mains Powered

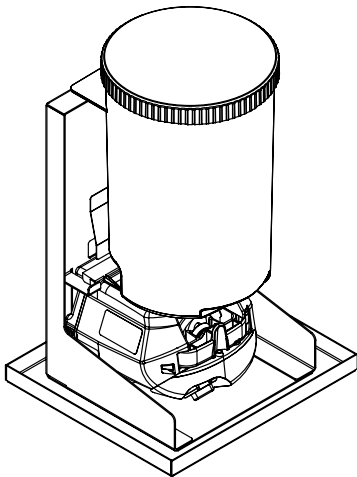

**Modulo Slimline 2L Soap Dispenser**

92400BK Battery Powered

92401BK Mains Powered

---

**Large capacity touch-free soap dispenser that works in conjunction with the Modulo Slimline Cabinet. Available as both battery operated or mains powered.**

Product Image:



Product Description:

- Large 2L capacity ideal for busy washrooms, holds enough soap for 3,200 dispenses
- Reservoir is quick and easy to refill
- Dispensing pump is compatible with liquid soap formulations
- Battery powered unit uses 4 x C Cell Batteries
- Mains powered unit adapts 240v supply to 5V

When used with the Modulo Slimline Cabinet:

- Base plate sits on fixings within the cabinet and is secured into place
- Dispenser can be positioned in multiple locations within the cabinet
- Dispensers and consumables are protected by lockable cabinet door
- Utilises half a modular cabinet space
- Blanking plates available separately if required
- Spare consumables can be conveniently stored on the shelf within the Modulo Slimline cabinet

When used with the Modulo Slimline Shelf:

- Base plate sits on fixings on the shelf and is secured into place
- Dispenser can be positioned in multiple locations on the shelf
- Utilises half a modular shelf space
- Blanking plates available separately if required

Installation options:

- Compatible with the Modulo Slimline Cabinets - available separately
- Compatible with the Modulo Slimline Shelves - available separately
- Suitable for installation within a bespoke cabinet or shelf

# Technical Data Sheet



## Modulo Slimline 2L Soap Dispenser

92400BK Battery Powered

92401BK Mains Powered

### Product Specification:

|                        |   |
|------------------------|---|
| <b>Material:</b>       | EN 1.4509 Stainless Steel + mixed material components |
| <b>Dimensions:</b>     | W.193mm x H.293mm x D.173mm                           |
| <b>Finish:</b>         | Matte black powder coated                             |
| <b>Weight:</b>         | tbc   |
| <b>Packing/Carton:</b> | 1 piece   |
| <b>Warranty:</b>       | 10 years  |

### Line Drawing:

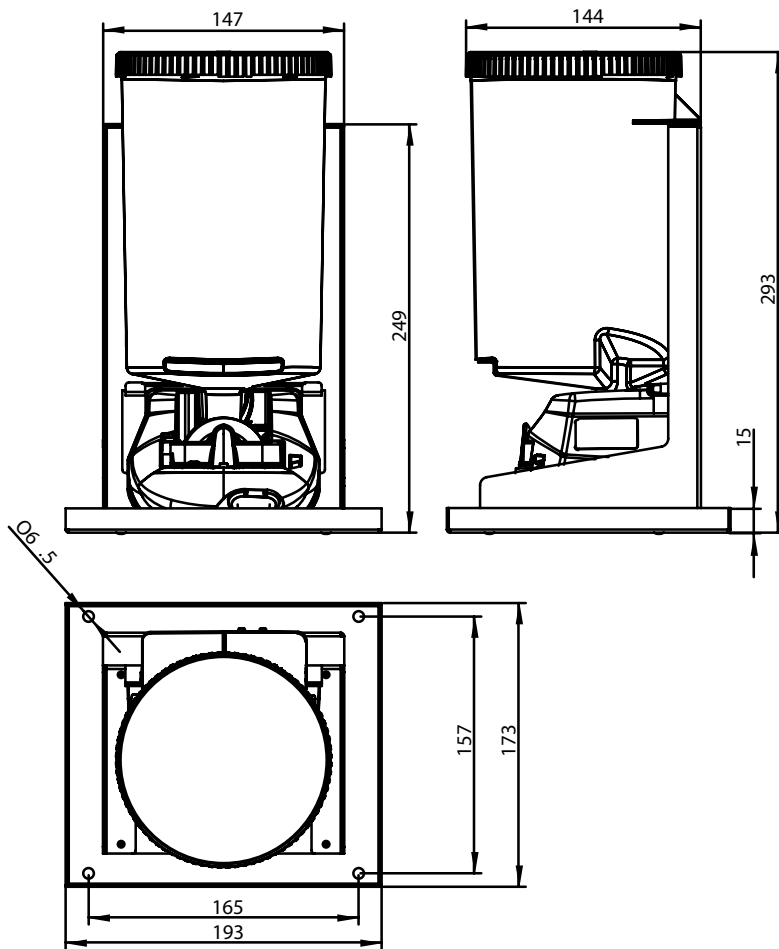

# Technical Data Sheet

## Modulo Slimline 2L Soap Dispenser

92400BK Battery Powered

92401BK Mains Powered



### Configuration suggestions:

#### 1200mm Unit:

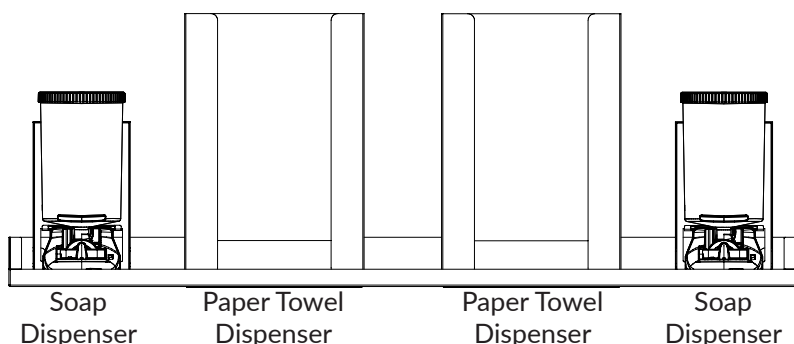
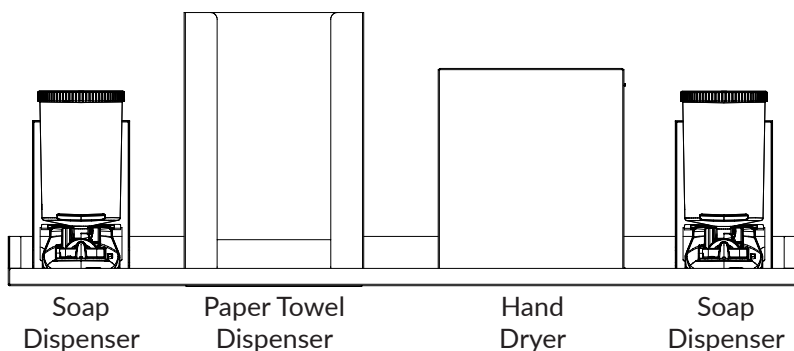
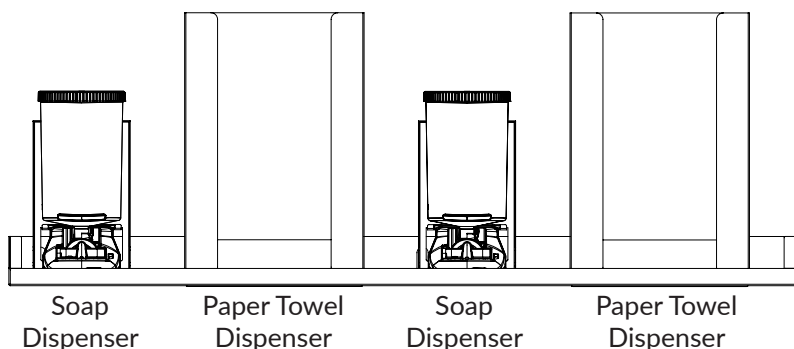

#### 600mm Unit:

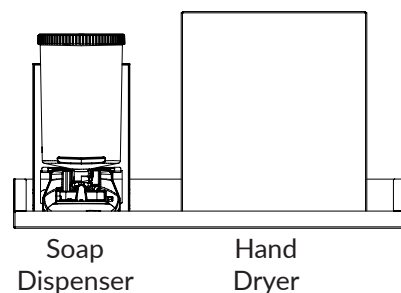
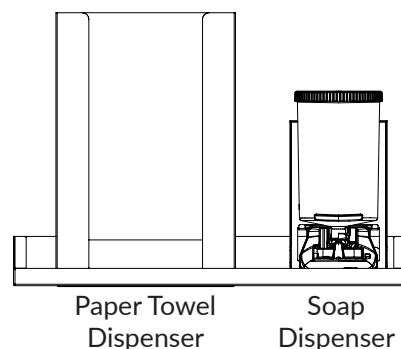

Dudley Industries Ltd  
Preston Road, Lytham St Annes, Lancashire. FY8 5AT



Tel: +44 (0) 1253 738311  
Email: [sales@dudleyindustries.com](mailto:sales@dudleyindustries.com)  
Web: [www.dudleyindustries.com](http://www.dudleyindustries.com)